

**GENERAL FEATURE**

Floating ball / *Boisseau flottant*  
 3 pieces Construction / *Construction 3 pièces*  
 Full bore / *Passage intégral*  
 Soft seat / *Siège souple*  
 Bidirectional  
 TA-LUFT  
 Anti Blow out proof stem.  
 Autoadjustable packing.  
 Anti static device.  
 Self-cavity relief

**STANDARDS**

Marking : MSS SP25  
 Top flange ISO 5211  
 Testing API 598, Rate A  
 Design : selon B16-34  
 SW Connections : ASME B16.11  
 BW Connections : ASME B16.5 (ou B16.25)  
 MATERIAL : ASTM and NACE MR0175-0103 (wetted parts)

**OFFICIAL APPROVALS**

CERTIFICATE FIRE SAFE  
 ISO 15848 RATE B  
 ATEX 94-9EC  
 PED Module H CAT III  
 SIL 3  
 EN 161/EN 264

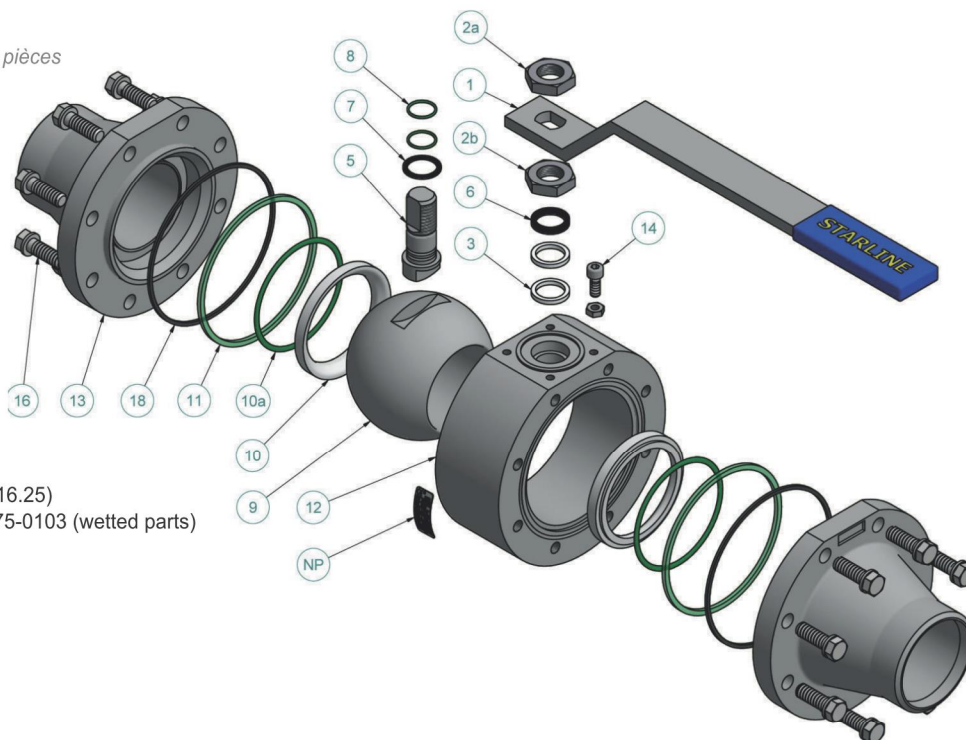

ITEM NO	QTY	PART NAME	NOMENCLATURE	CARBON STEEL MATERIAL 115 SGSG-CL400	STAINLESS STEEL MATERIAL 116 SGSG-CL400
NP	1	Name plate	Plaque d'identification	AISI 316	AISI 316
1	1	Handle	Levier	Carbon steel + Epoxy coated	Carbon steel + Epoxy coated
2a	2	Handle nut	Ecrou levier	AISI 316	AISI 316
2b					
3	1	Packing ring	Garniture	Graphite	Graphite
4	2	Spring washers	Rondelle ressort	AISI 316 Treated	AISI 316 Treated
5	1	Antistatic stem	Tige antistatique	AISI 316/316L Dual Certified	AISI 316/316L Dual Certified
6	1	Gland packing	Fouloir	AISI 316	AISI 316
7	1	Thrust washer	Rondelle butée	PTFE	PTFE
8	2	"O" ring stem	Joint torique	Viton	Viton
9	1	Ball	Sphère	AISI 316/316L Dual Certified	AISI 316/316L Dual Certified
10	2	Seats	Sièges	"RPTFE"	"RPTFE"
10a	2	Seats gasket	Joint de sièges	Viton	Viton
11	2	1° Body seals	1° Joint de corps	"RPTFE"	"RPTFE"
12	1	Body	Corps	LF2	AISI 316/316L Dual Certified
13	2	End connections	Embout	LF2	AISI 316/316L Dual Certified
14	1	Stop-pin	Butée	AISI 316	AISI 316
16	16	Bolts	Vis	L7 + Zinc Plated	B8
18	2	2° Body seals	2° Joint de corps	Graphite	Graphite

# SUPER STAR N°1

## FLOATING BALL VALVE

CLASS 400 - DN80 - "3" FB

Fig: 115SGS /116SGSG

RACCORDEMENT **A SOUDER**

**WELDING ENDS**

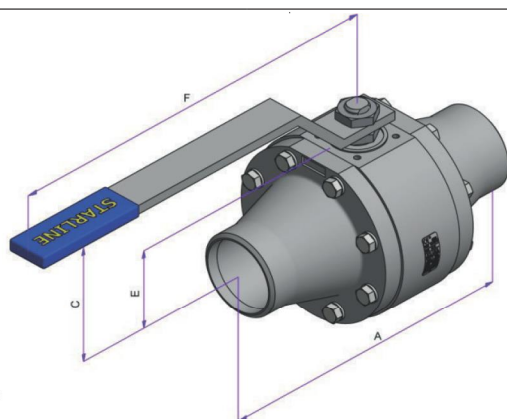

**BW-PE**

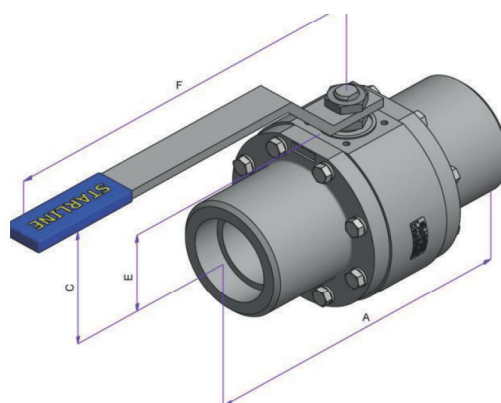

**SW**

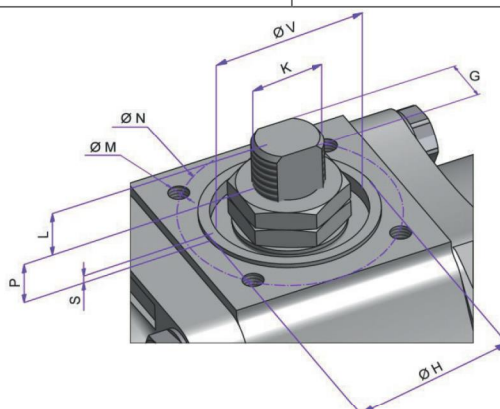

**TOP  
VIEW**

FULL BORE							TOP MOUNTING												
VALVE SIZE		DIMENSION [ mm ]					WEIGHT [ kg ]	DIMENSIONS [ mm ]								ISO 5211	TORQUE [N.m]	MAST [N.m]	
NPS	DN	A	BORE	C	E	F	BW-PE-SW	L	P	S	V	K	G	H	N				M
3" x 3"	80 x 80	305	76	150	87	420	26.5	15	22.5	1.5	48	M24x2	18	55	70	M8x12	F07	107	501

- Net torque mesured with clean water at ambiant temperature

- Mast for AISI 316 material

### PRESSURE/TEMPERATURE LIMITATION OF SEAT SEAL (according working conditions)

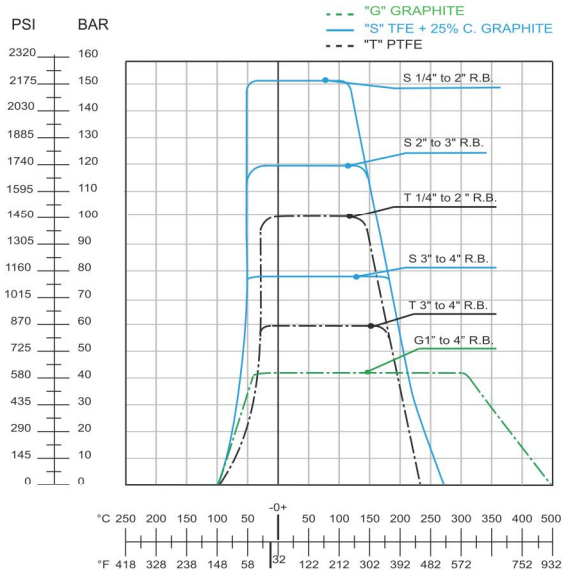

### DIFFERENT CONFIGURATIONS (others on request)

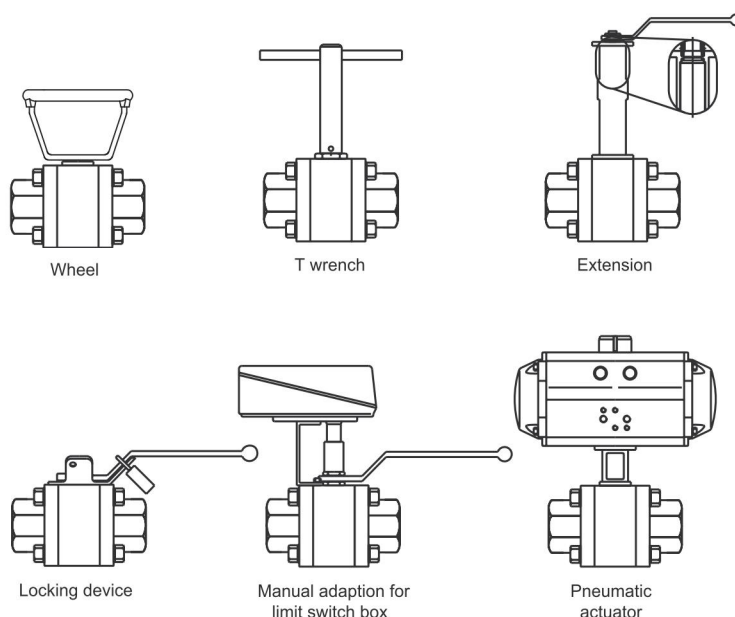

star-line.fr - infos@star-line.fr - +33 4 42 87 84 00  
ref n° DS1085 Rev0 (datas not contractual)