

GENERAL FEATURE

Floating ball / *Boisseau flottant*
3 pieces Construction / *Construction 3 pièces*
Full bore / *Passage intégral*
Soft seat / *Siège souple*
Bidirectional
TA-LUFT
Anti Blow out proof stem.
Autoadjustable packing.
Anti static device.
Self-cavity relief

STANDARDS

Marking : MSS SP25
Top flange ISO 5211
Testing API 598, Rate A
Design : selon B16-34
NPT Connections : ASME B1.20.1
BSPP Connections : ISO 228/1
BSPT Connections : ISO 7/1
MATERIAL : ASTM and NACE MR0175-0103 (wetted parts)

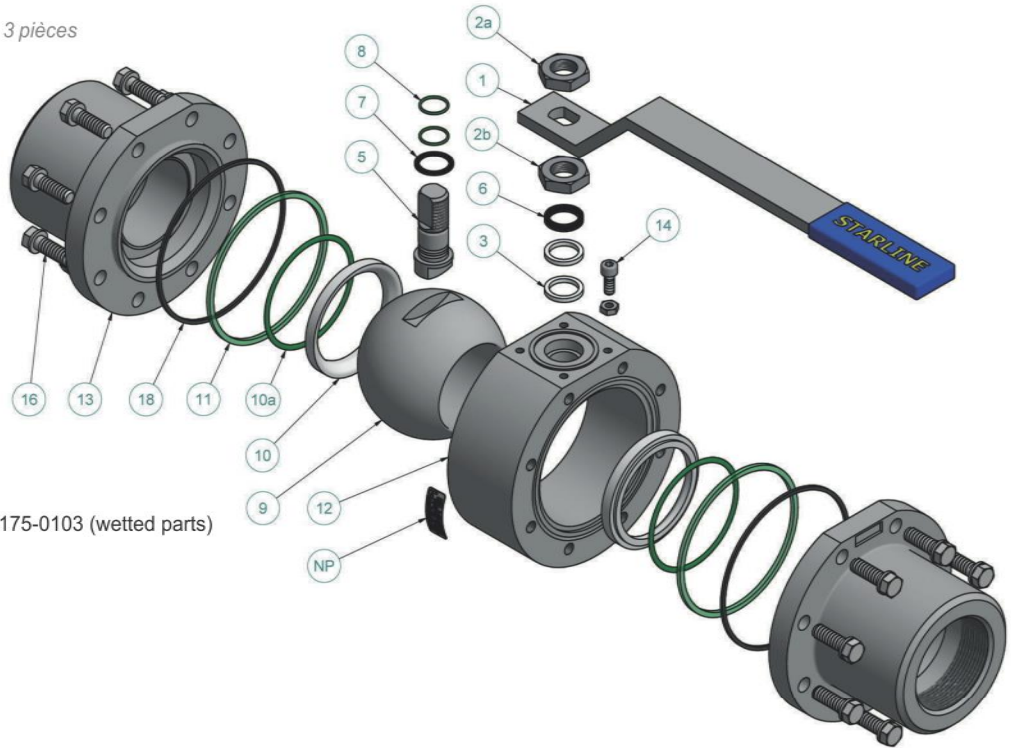

OFFICIAL APPROVALS

FIRE SAFE
ISO 15848 RATE B
ATEX IM2 / II 2 GD
PED Module H CAT III
SIL 3
EN 161/EN 264



ITEM NO	QTY	PART NAME	NOMENCLATURE	CARBON STEEL MATERIAL 115 SGSG-CL150-400	STAINLESS STEEL MATERIAL 115 SGSG-CL150-400
NP	1	Name plate	Plaque d'identification	AISI 316	AISI 316
1	1	Handle	Levier	Carbon steel + Epoxy coated	Carbon steel + Epoxy coated
2a	2	Handle nut	Ecrou levier	AISI 316	AISI 316
2b					
3	1	Packing ring	Garniture	Graphite	Graphite
4	2	Spring washers	Rondelle ressort	AISI 316 Treated	AISI 316 Treated
5	1	Antistatic stem	Tige antistatique	AISI 316/316L Dual Certified	AISI 316/316L Dual Certified
6	1	Gland packing	Fouloir	AISI 316	AISI 316
7	1	Thrust washer	Rondelle butée	PTFE	PTFE
8	1	"O" ring stem	Joint torique	Viton	Viton
9	1	Ball	Sphère	AISI 316/316L Dual Certified	AISI 316/316L Dual Certified
10	2	Seats	Sièges	"RPTE"	"RPTE"
10a	2	Seats gasket	Joint de sièges	Viton	Viton
11	2	1° Body seals	1° Joint de corps	"RPTE"	"RPTE"
12	1	Body	Corps	LF2	AISI 316/316L Dual Certified
13	2	End connections	Embout	LF2	AISI 316/316L Dual Certified
14	1	Stop-pin	Butée	AISI 316	AISI 316
16	16	Bolts	Vis	L7 + Zinc Plated	B8
18	2	2° Body seals	2° Joint de corps	Graphite	Graphite

SUPER STAR N°1
FLOATING BALL VALVE

CLASS 150+400 - DN80 FB - 3" FB

Fig: 115SGS /116SGSG

RACCORDEMENT **A VISSER**

SCREWED ENDS

NPT-BSPP-BSPT

TOP VIEW

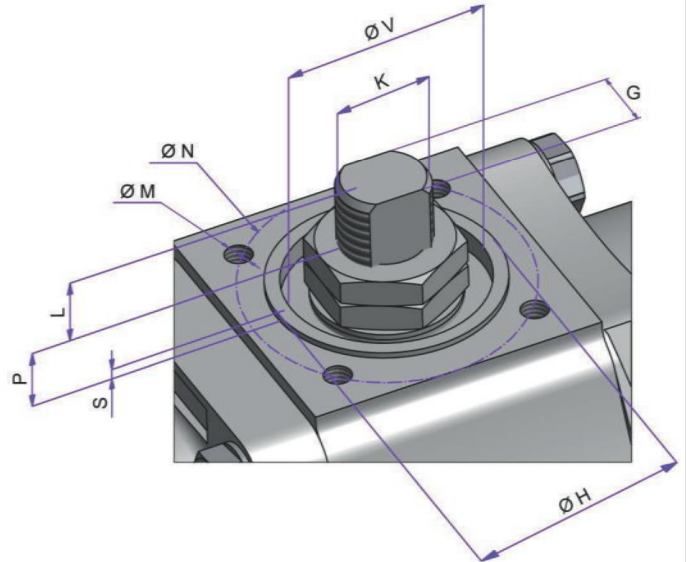
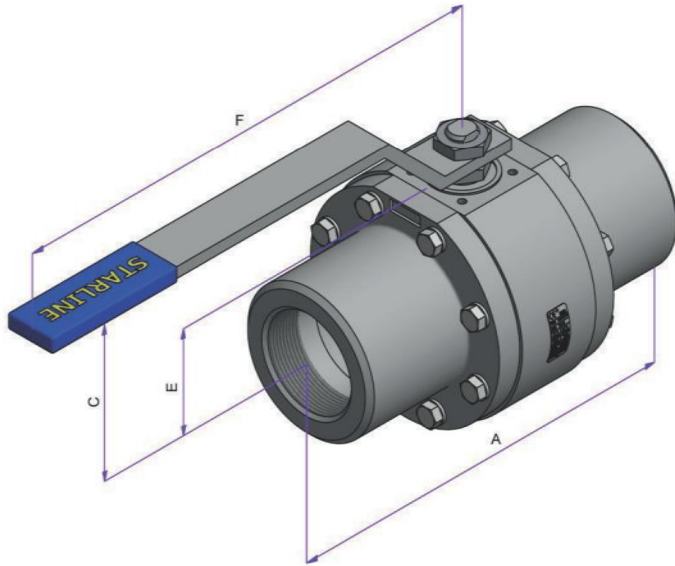

FULL BORE							TOP MOUNTING											ISO 5211	TORQUE [N.m]	MAST [N.m]
VALVE SIZE		DIMENSION [mm]					WEIGHT [kg]	DIMENSIONS [mm]												
NPS	DN	A	BORE	C	E	F	NPT-BSPP-BSPT	L	P	S	V	K	G	H	N	M				
3" x 3"	80 x 80	305	76	150	87	420	26.5	15	22.5	1.5	48	M24x2	18	55	70	M8x12	F07	107	501	

- Net torque measured with clean water at ambient temperature

- Mast for AISI 316 material

PRESSURE/TEMPERATURE LIMITATION OF SEAT SEAL (according working conditions)

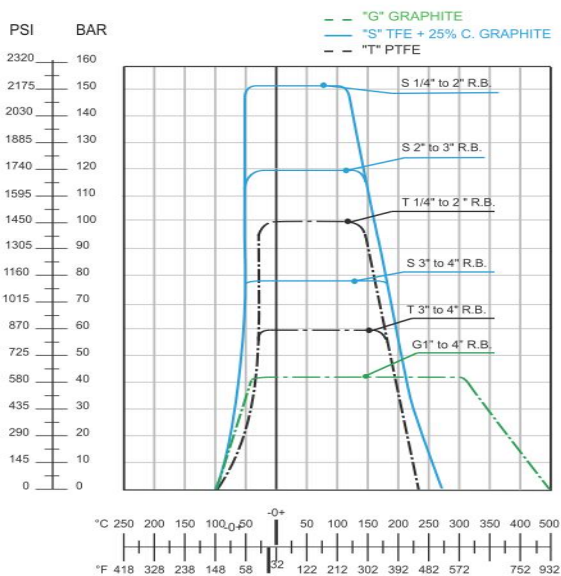

DIFFERENT CONFIGURATIONS (others on request)

