

**GENERAL FEATURE**

Floating ball / Boisseau flottant  
3 pieces Construction / Construction 3 pièces  
Reduced bore / Passage réduit  
Soft seat / Siège souple  
Bidirectional  
TA-LUFT  
Anti Blow out proof stem.  
Autoadjustable packing.  
Anti static device.  
Self-cavity relief

**STANDARDS**

Marking : MSS SP25  
Top flange ISO 5211  
Testing API 598, Rate A  
Design : selon B16-34  
NPT Connections : ASME B1.20.1  
BSPP Connections : ISO 228/1  
BSPT Connections : ISO 7/1  
MATERIAL : ASTM and NACE MR0175-0103 (wetted parts)

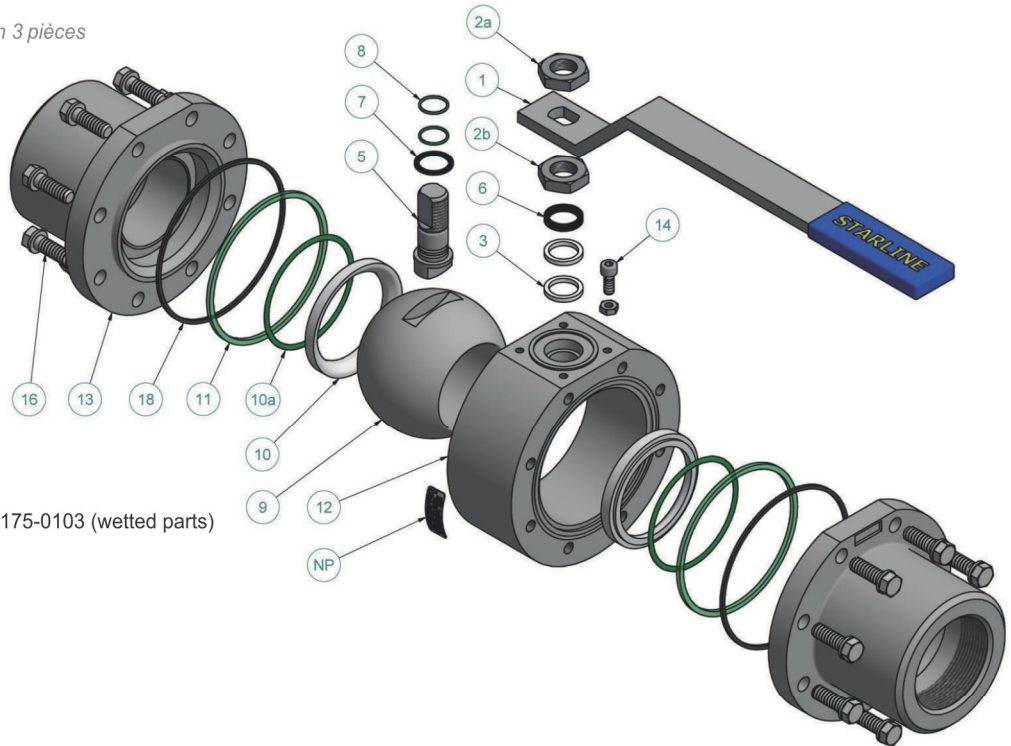

**OFFICIAL APPROVALS**

CERTIFICATE FIRE SAFE  
ISO 15848 RATE B  
ATEX 94-9EC  
PED Module H CAT III  
SIL 3  
EN 161/EN 264



ITEM NO	QTY	PART NAME	NOMENCLATURE	CARBON STEEL MATERIAL 215 SGSG-CL150-400	STAINLESS STEEL MATERIAL 215 SGSG-CL150-400
NP	1	Name plate	Plaque d'identification	AISI 316	AISI 316
1	1	Handle	Levier	Carbon steel + Epoxy coated	Carbon steel + Epoxy coated
2a	2	Handle nut	Ecrou levier	AISI 316	AISI 316
2b					
3	1	Packing ring	Garniture	Graphite	Graphite
4	2	Spring washers	Rondelle ressort	AISI 316 Treated	AISI 316 Treated
5	1	Antistatic stem	Tige antistatique	AISI 316/316L Dual Certified	AISI 316/316L Dual Certified
6	1	Gland packing	Fouloir	AISI 316	AISI 316
7	1	Thrust washer	Rondelle butée	PTFE	PTFE
8	1	"O" ring stem	Joint torique	Viton	Viton
9	1	Ball	Sphère	AISI 316/316L Dual Certified	AISI 316/316L Dual Certified
10	2	Seats	Sièges	"RPTFE"	"RPTFE"
10a	2	Seats gasket	Joint de sièges	Viton	Viton
11	2	1° Body seals	1° Joint de corps	"RPTFE"	"RPTFE"
12	1	Body	Corps	LF2	AISI 316/316L Dual Certified
13	2	End connections	Embout	LF2	AISI 316/316L Dual Certified
14	1	Stop-pin	Butée	AISI 316	AISI 316
16	16	Bolts	Vis	L7 + Zinc Plated	B8
18	2	2° Body seals	2° Joint de corps	Graphite	Graphite

# SUPER STAR N°1

## FLOATING BALL VALVE

CLASS 400 - DN100 RB - 4" RB

Fig: 215SGS /216SGSG

RACCORDEMENT **A VISSER**

**SCREWED ENDS**

### NPT-BSPP-BSPT

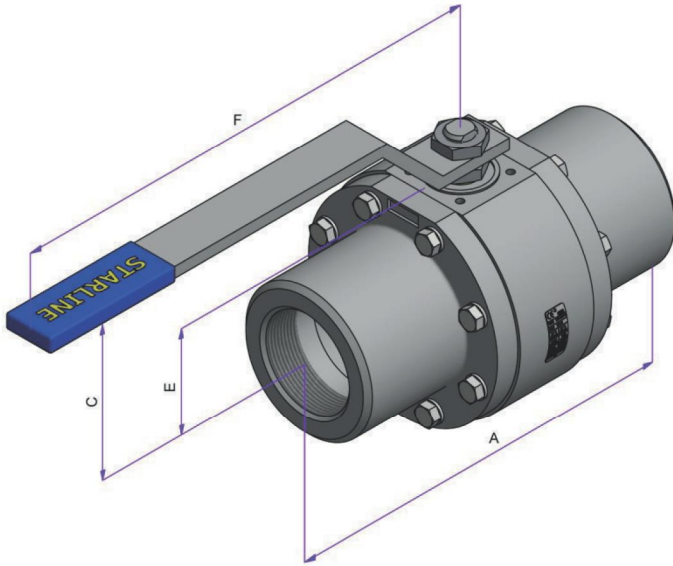

### TOP VIEW

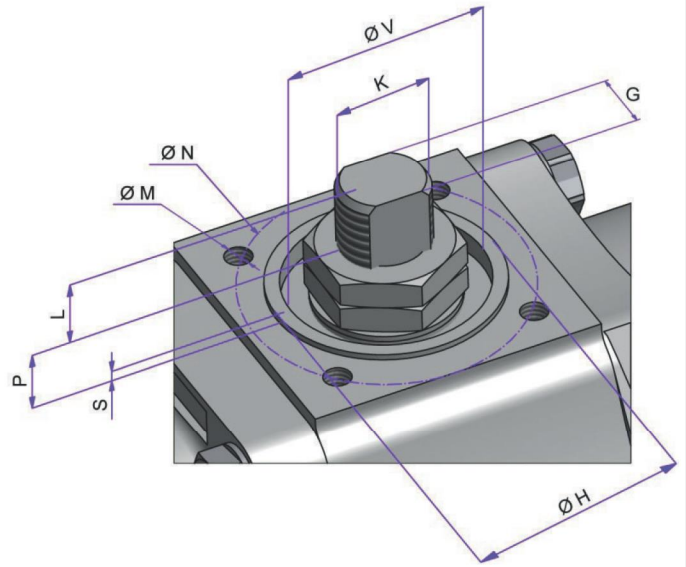

#### REDUCED BORE

#### TOP MOUNTING

VALVE SIZE		DIMENSION [ mm ]					WEIGHT [ kg ]	DIMENSIONS [ mm ]									ISO 5211	TORQUE [N.m]	MAST [N.m]
NPS	DN	A	BORE	C	E	F	NPT-BSPP-BSPT	L	P	S	V	K	G	H	N	M			
4" x 3"	100 x 80	229	76	150	87	420	25.5	15	22.5	1.5	48	M24x2	18	55	70	M8x12	F07	107	501

- Net torque mesured with clean water at ambient temperature

- Mast for AISI 316 material

### PRESSURE/TEMPERATURE LIMITATION OF SEAT SEAL (according working conditions)

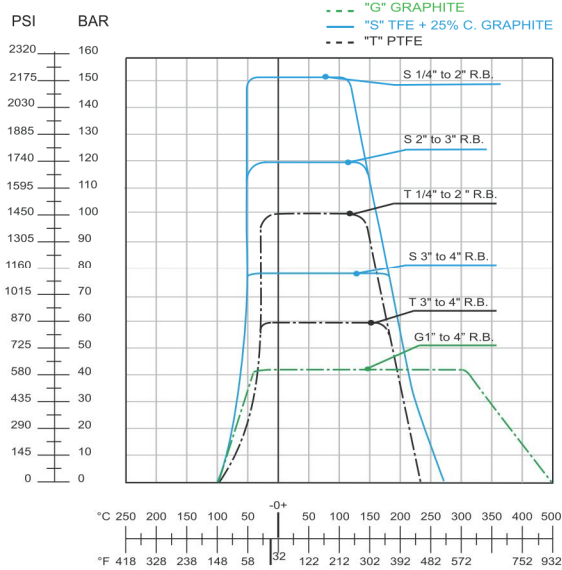

### DIFFERENT CONFIGURATIONS (others on request)

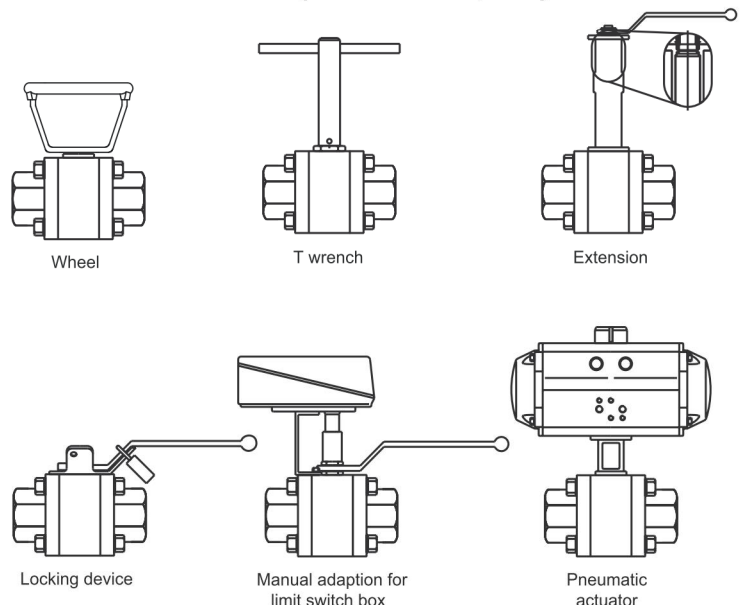

star-line.fr - infos@star-line.fr - +33 4 42 87 84 00  
 ref n° DS1065 Rev0 (datas not contractual)