

GENERAL FEATURE

Floating ball / Boisseau flottant
 3 pieces Construction / Construction 3 pièces
 Reduced bore / Passage réduit
 Soft seat / Siège souple
 Bidirectional
 TA-LUFT
 Anti Blow out proof stem.
 Autoadjustable packing.
 Anti static device.
 Self-cavity relief

STANDARDS

Marking : MSS SP25
 Top flange : ISO 5211
 Testing : API 598, Rate A
 Design : selon B16-34
 FLANGED Connections : ASME B16.5 - B16.10
 MATERIAL : ASTM and NACE MR0175-0103 (wetted parts)

OFFICIAL APPROVALS

FIRE SAFE
 ISO 15848 RATE B
 ATEX IM2 / II 2 GD
 PED Module H CAT III
 SIL 3
 EN 161/EN 264

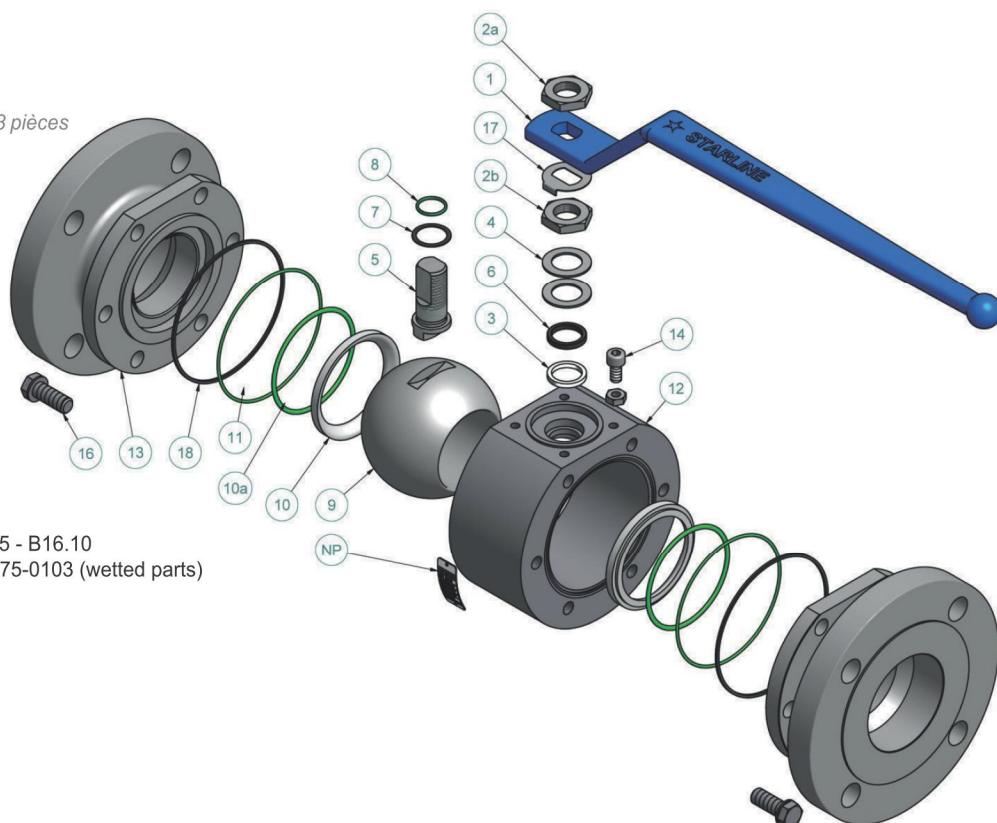

ITEM NO	QTY	PART NAME	NOMENCLATURE	CARBON STEEL MATERIAL 215 SGSG-CL150	STAINLESS STEEL MATERIAL 216 SGSG-CL150
NP	1	Name plate	Plaque d'indentification	AISI 316	AISI 316
1	1	Handle	Levier	Carbon steel + Epoxy coated ^{Note1}	Carbon steel + Epoxy coated ^{Note1}
2a	2	Handle nut	Ecrou levier	AISI 316	AISI 316
2b					
3	1 ^{Note2}	Packing ring	Garniture	Graphite	Graphite
4	1 ^{Note3}	Spring washers	Rondelle ressort	AISI 316 Treated	AISI 316 Treated
5	1	Antistatic stem	Tige antistatique	AISI 316/316L Dual Certified	AISI 316/316L Dual Certified
6	1 ^{Note4}	Gland packing	Fouloir	AISI 316	AISI 316
7	1	Thrust washer	Rondelle butée	PTFE	PTFE
8	1 ^{Note2}	"O" ring stem	Joint torique	Viton	Viton
9	1	Ball	Sphère	AISI 316/316L Dual Certified	AISI 316/316L Dual Certified
10	2	Seats	Sièges	"RPTFE"	"RPTFE"
10a	2	Seats gasket	Joint de sièges	Viton	Viton
11	2	1° Body seals	1° Joint de corps	"RPTFE"	"RPTFE"
12	1	Body	Corps	LF2	AISI 316/316L Dual Certified
13	2	End connections	Embout	LF2	AISI 316/316L Dual Certified
14	1	Stop-pin	Butée	AISI 316	AISI 316
16	12 ^{Note5}	Bolts	Vis	L7 + Zinc Plated	B8
17	1 ^{Note6}	Stop washer	Rondelle frein	AISI 316	AISI 316
18	2	2° Body seals	2° Joint de corps	Graphite	Graphite

Note 1: Carbon Steel + Plastic from DN 80 - 3" to DN 100 - 4"

Note 2: Qty 2 for DN 100 - 4"

Note 3: Qty 0 for DN 100 - 4"

Note 4: Qty 2 for DN 25 - 1"

Note 5: Qty 16 for DN 100 - 4"

Note 6: Qty 0 for DN 80 - 3" and Over

SUPER STAR N°1

FLOATING BALL VALVE

CLASS 150 - DN65+100 RB - 2.1/2"+4" RB

Fig: 215SGS /216SGS

RACCORDEMENT A **BRIDES**

FLANGED ENDS

RF-RTJ

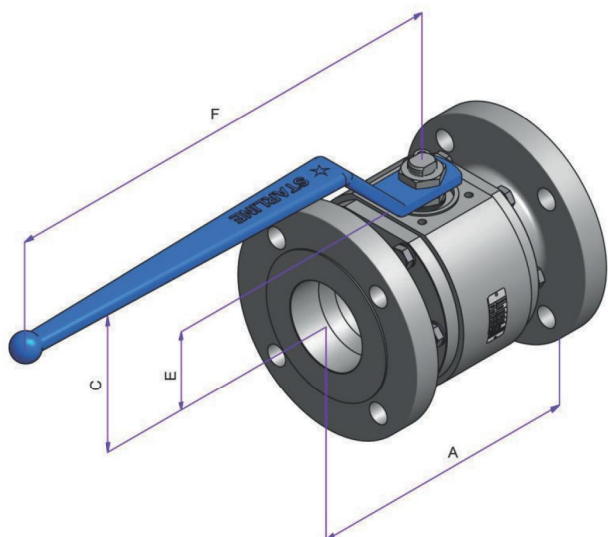

TOP VIEW

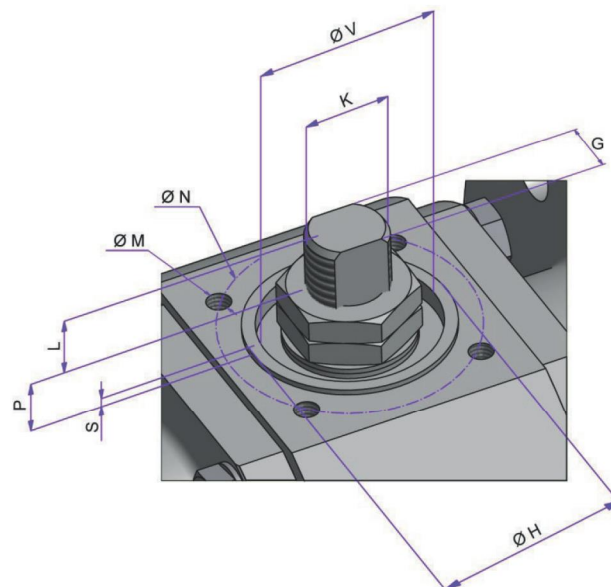

REDUCED BORE										TOP MOUNTING											
VALVE SIZE		DIMENSION [mm]						WEIGHT [kg]		DIMENSIONS [mm]								ISO 5211	TORQUE [N.m]	MAST [N.m]	
NPS	DN	A		BORE	C	E	F	RF	RTJ	L	P	S	V	K	G	H	N				M
2.1/2" x 2"	65 x 50	191	203	49	122	58.7	218	14.5	15	12.5	12.5	1.5	30	M15x1.5	8,9	35	50	M6x10	F05	68	180
3" x 2.1/2"	80 x 65	203	216	62	136	70	420	20	21	17	18	1.5	48	M22x1.5	16	55	70	M8x12	F07	80	386
4" x 3"	100 x 80	229	241	76	150	87	420	34	34.5	15	22.5	1.5	48	M24x1.5	18	55	70	M8x12	F07	96	501

- Net torque measured with clean water at ambient temperature

- Mast for AISI 316 material

PRESSURE/TEMPERATURE LIMITATION OF SEAT SEAL (according working conditions)

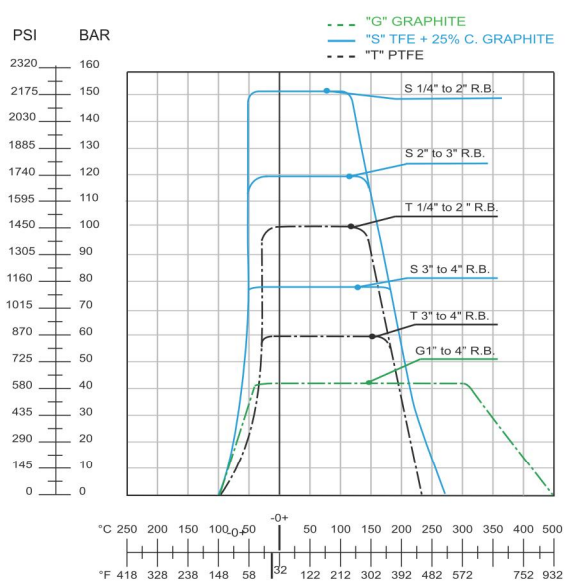

DIFFERENT CONFIGURATIONS (others on request)

