

GENERAL FEATURE

Floating ball / Boisseau flottant
 3 pieces Construction / Construction 3 pièces
 Reduced bore / Passage réduit
 Soft seat / Siège souple
 Bidirectional
 TA-LUFT
 Anti Blow out proof stem.
 Autoadjustable packing.
 Anti static device.
 Self-cavity relief

STANDARDS

Marking : MSS SP25
 Top flange ISO 5211
 Testing API 598, Rate A
 Design : selon B16-34
 SW Connections : ASME B16.11
 BW Connections : ASME B16.5 (ou B16.25)
 MATERIAL : ASTM and NACE MR0175-0103 (wetted parts)

OFFICIAL APPROVALS

CERTIFICATE FIRE SAFE
 ISO 15848 RATE B
 ATEX 94-9EC
 PED Module H CAT III
 SIL 3
 EN 161/EN 264

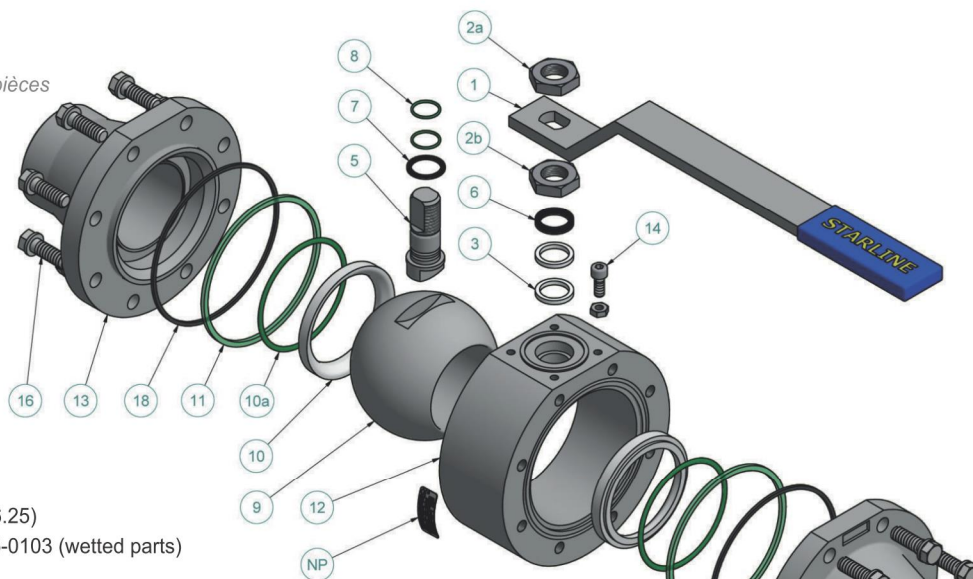

ITEM NO	QTY	PART NAME	NOMENCLATURE	CARBON STEEL MATERIAL 215 SGSG-CL400	STAINLESS STEEL MATERIAL 216 SGSG-CL400
NP	1	Name plate	Plaque d'identification	AISI 316	AISI 316
1	1	Handle	Levier	Carbon steel + Epoxy coated	Carbon steel + Epoxy coated
2a	2	Handle nut	Ecrou levier	AISI 316	AISI 316
2b					
3	1	Packing ring	Garniture	Graphite	Graphite
4	2	Spring washers	Rondelle ressort	AISI 316 Treated	AISI 316 Treated
5	1	Antistatic stem	Tige antistatique	AISI 316/316L Dual Certified	AISI 316/316L Dual Certified
6	1	Gland packing	Fouloir	AISI 316	AISI 316
7	1	Thrust washer	Rondelle butée	PTFE	PTFE
8	2	"O" ring stem	Joint torique	Viton	Viton
9	1	Ball	Sphère	AISI 316/316L Dual Certified	AISI 316/316L Dual Certified
10	2	Seats	Sièges	"RPTFE"	"RPTFE"
10a	2	Seats gasket	Joint de sièges	Viton	Viton
11	2	1° Body seals	1° Joint de corps	"RPTFE"	"RPTFE"
12	1	Body	Corps	LF2	AISI 316/316L Dual Certified
13	2	End connections	Embout	LF2	AISI 316/316L Dual Certified
14	1	Stop-pin	Butée	AISI 316	AISI 316
16	16	Bolts	Vis	L7 + Zinc Plated	B8
18	2	2° Body seals	2° Joint de corps	Graphite	Graphite

SUPER STAR N°1
FLOATING BALL VALVE

CLASS 400 - DN100 RB - 4" RB
Fig: 215SGS /216SGS

RACCORDEMENT **A SOUDER**
WELDING ENDS

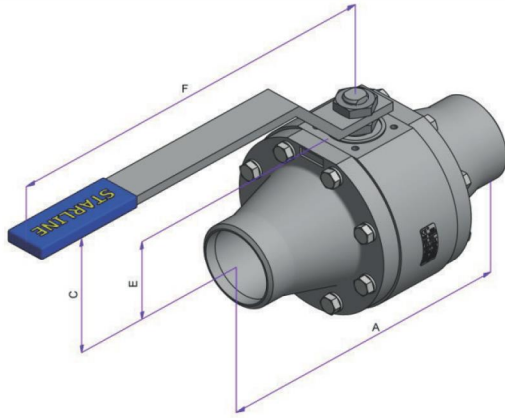

BW-PE

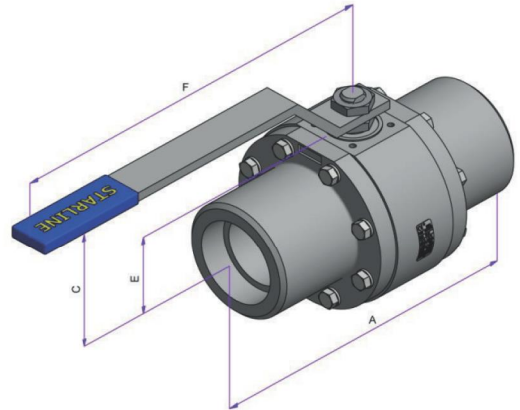

SW

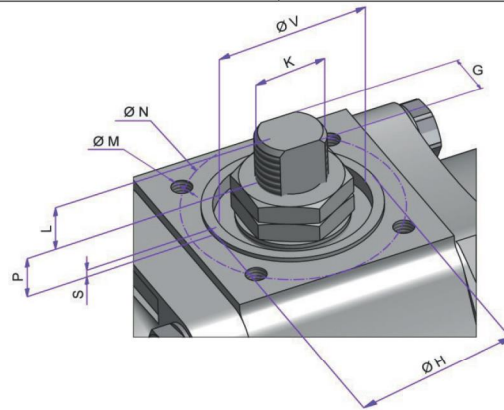

TOP VIEW

REDUCED BORE							TOP MOUNTING										ISO 5211	TORQUE [N.m]	MAST [N.m]
VALVE SIZE		DIMENSION [mm]					WEIGHT [kg]	DIMENSIONS [mm]											
NPS	DN	A	BORE	C	E	F	NPT-BSPP-BSPT	L	P	S	V	K	G	H	N	M			
4" x 3"	100 x 80	305	76	150	87	420	25.5	15	22.5	1.5	48	M24x2	18	55	70	M8x12	F07	107	501

- Net torque mesured with clean water at ambient temperature

- Mast for AISI 316 material

PRESSURE/TEMPERATURE LIMITATION OF SEAT SEAL (according working conditions)

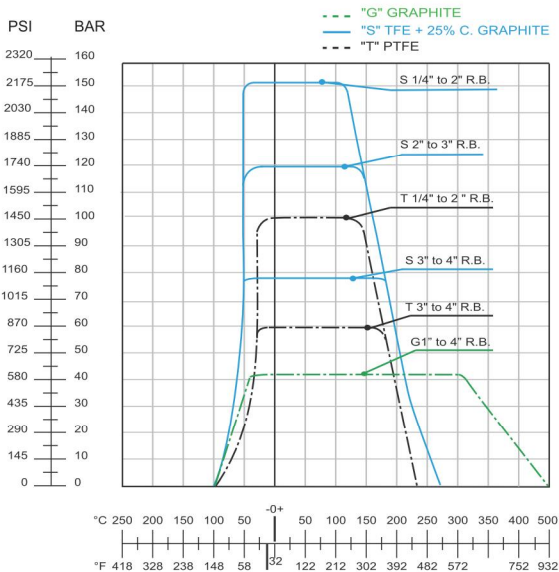

DIFFERENT CONFIGURATIONS (others on request)

