

**GENERAL FEATURE**

Floating ball / Boisseau flottant  
3 pieces Construction / Construction 3 pièces  
Reduced bore / Passage réduit  
Soft seat / Siège souple  
Bidirectional  
TA-LUFT  
Anti Blow out proof stem.  
Autoadjustable packing.  
Anti static device.  
Self-cavity relief

**STANDARDS**

Marking : MSS SP25  
Top flange : ISO 5211  
Testing : API 598,  
Design : selon B16-34  
FLANGED Connections : EN 558 series 1  
MATERIAL : ASTM and NACE MR0175-0103 (wetted parts)

**OFFICIAL APPROVALS**

FIRE SAFE  
ISO 15848 RATE B  
ATEX IM2 / II 2 GD  
PED Module H CAT III  
SIL 3  
EN 161/EN 264

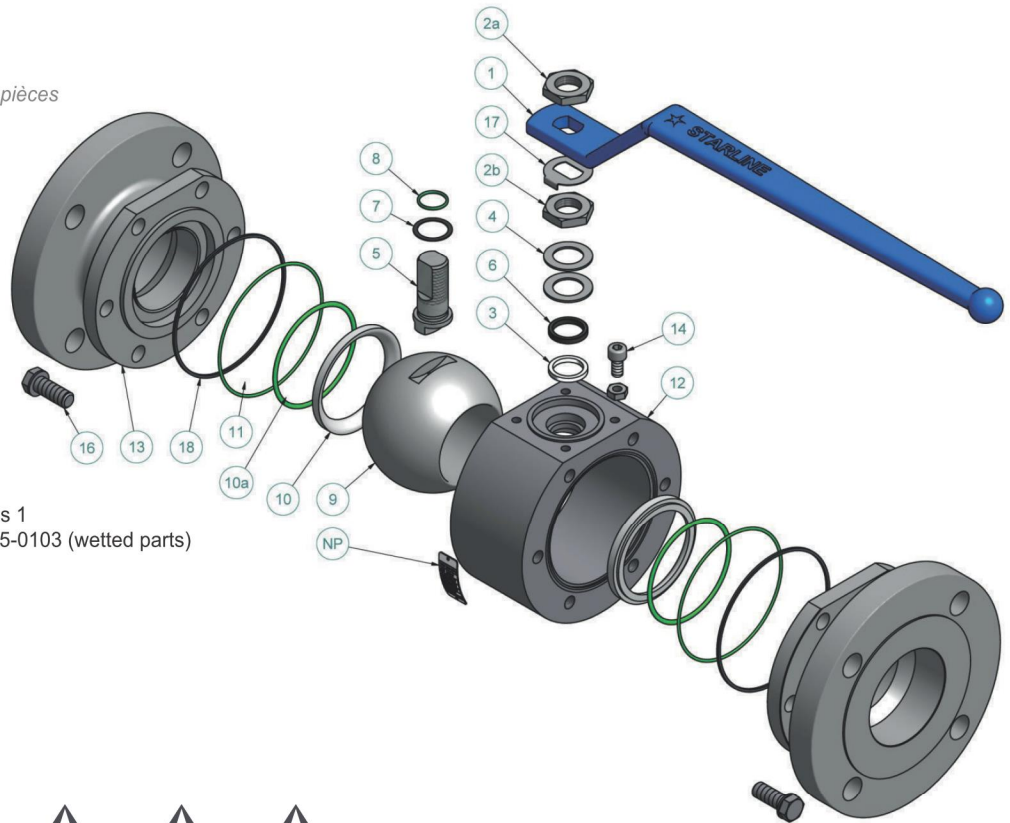

ITEM NO	QTY	PART NAME	NOMENCLATURE	CARBON STEEL MATERIAL 215 SGSG-PN40	STAINLESS STEEL MATERIAL 216 SGSG-PN40
NP	1	Name plate	Plaque d'indentification	AISI 316	AISI 316
1	1	Handle	Levier	Carbon steel + Epoxy coated <sup>Note1</sup>	Carbon steel + Epoxy coated <sup>Note1</sup>
2a	2	Handle nut	Ecrou levier	AISI 316	AISI 316
2b					
3	1 <sup>Note2</sup>	Packing ring	Garniture	Graphite	Graphite
4	2 <sup>Note3</sup>	Spring washers	Rondelle ressort	AISI 316 Treated	AISI 316 Treated
5	1	Antistatic stem	Tige antistatique	AISI 316/316L Dual Certified	AISI 316/316L Dual Certified
6	1 <sup>Note4</sup>	Gland packing	Fouloir	AISI 316	AISI 316
7	1	Thrust washer	Rondelle butée	PTFE	PTFE
8	1 <sup>Note2</sup>	"O" ring stem	Joint torique	Viton	Viton
9	1	Ball	Sphère	AISI 316/316L Dual Certified	AISI 316/316L Dual Certified
10	2	Seats	Sièges	"RPTFE"	"RPTFE"
10a	2	Seats gasket	Joint de sièges	Viton	Viton
11	2	1° Body seals	1° Joint de corps	"RPTFE"	"RPTFE"
12	1	Body	Corps	LF2	AISI 316/316L Dual Certified
13	2	End connections	Embout	LF2	AISI 316/316L Dual Certified
14	1	Stop-pin	Butée	AISI 316	AISI 316
16	12 <sup>Note5</sup>	Bolts	Vis	L7 + Zinc Plated	B8
17	1 <sup>Note6</sup>	Stop washer	Rondelle frein	AISI 316	AISI 316
18	2	2° Body seals	2° Joint de corps	Graphite	Graphite

Note 1: Carbon Steel + Plastic from DN 80 - 3" to DN 100-4"

Note 2: Qty 2 for DN 100-4"

Note 3: Qty 0 for DN 100-4"

Note 4: Qty 2 for DN 25 - 1"

Note 5: Qty 16 for DN 100 - 4"

Note 6: Qty 0 for DN 80 - 3" and Over

Recommended 2 years spare parts / Remplacement des pièces préconisé après 2 ans d'utilisation

# SUPER STAR N°1

## FLOATING BALL VALVE

PN40-DN65+100 RB - 2.1/2" + 4" RB EN558 SERIES 1

RACCORDEMENT A BRIDES

Fig: 215SGS /216SGSG

FLANGED ENDS

RF

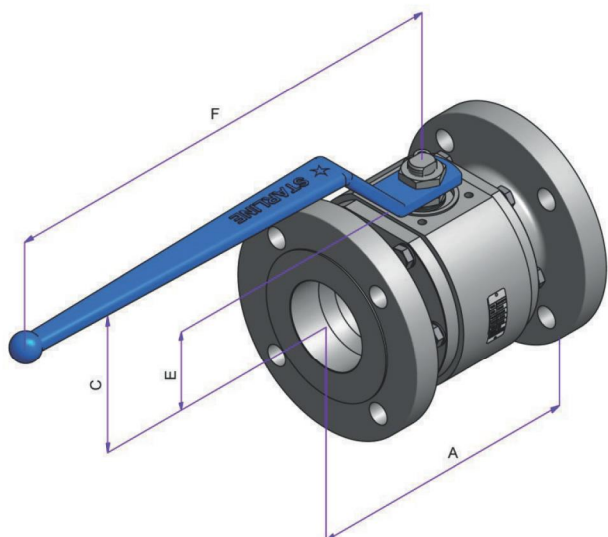

TOP VIEW

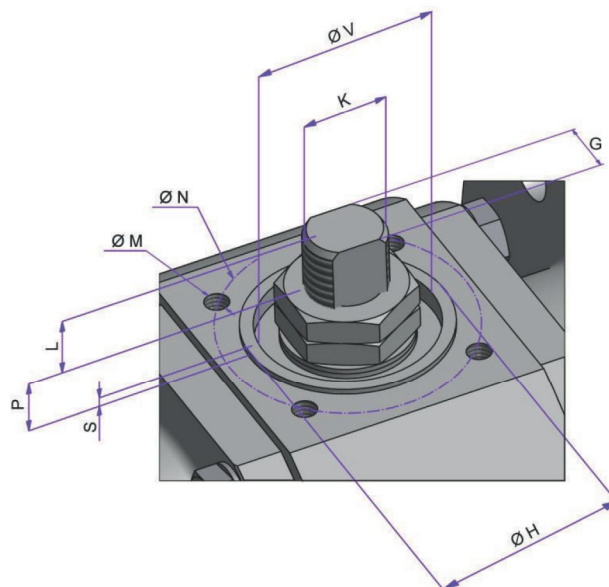

### REDUCED BORE

### TOP MOUNTING

VALVE SIZE		DIMENSION [ mm ]						WEIGHT [ kg ]	DIMENSIONS [ mm ]									ISO 5211	TORQUE [N.m]	MAST [N.m]
NPS	DN	A	BORE	C	E	F	PN 40	L	P	S	V	K	G	H	N	M				
2.1/2" x 2"	65 x 50	290	49	122	58.7	218	18.9	12.5	12.5	1.5	30	M15x1.5	8.9	35	50	M6x10	F05	72	180	
3" x 2.1/2"	80 x 65	310	62	136	70	420	24.5	17	18	1.5	48	M22x1.5	16	55	70	M8x12	F07	86	386	
4" x 3"	100 x 80	350	76	150	87	420	40.5	15	22.5	1.5	48	M24x1.5	18	55	70	M8x12	F07	107	501	

- Net torque measured with clean water at ambient temperature

- Mast for AISI 316 material

### PRESSURE/TEMPERATURE LIMITATION OF SEAT SEAL (according working conditions)

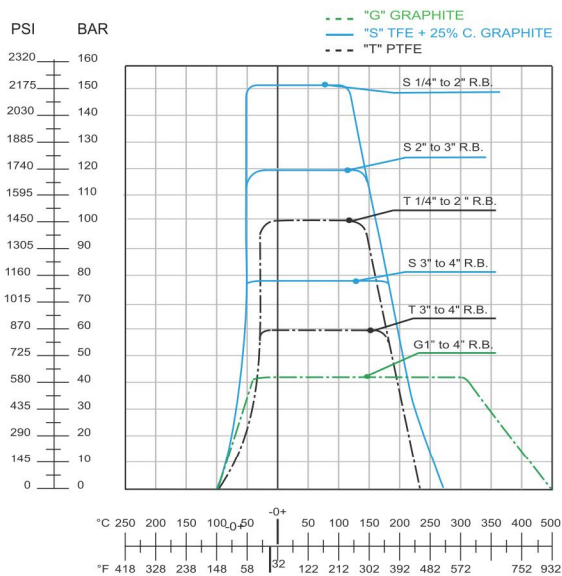

### DIFFERENT CONFIGURATIONS (others on request)

